

Loader Model : KL601 Tractor Model : RX6010C



Front Loader

The KL601 loader is equipped with a universal quick-attach mounting system that makes attaching the bucket as simple as latching an over-center latch. A built in parking stand on the front-end loader provides for quick and easy connection. The KL601 Loader utilizes the tractor's hydraulic system, features single-lever control with float, and comes with a bucket level indicator.



Deluxe Seat

The ergonomic, fully adjustable suspension seat allows the operator to ride comfortably, no matter what the job may be.



12x12 Fully Synchronized Transmission

The fully synchronized transmission provides smooth and easy shifting on the move. The transmission features 12 forward and 12 reverse gears to handle all kinds of jobs.

Loader Specification

MODEL	KL601
Maximum Lift Height	114.2"
Clearance w/ Attachment Level	102.7"
Clearance w/ Attachment Dumped	85.4"
Reach at Maximum Height	22.2"
Maximum Dump Angle	71°
Reach w/ Attachment on Ground	73.5"
Maximum Rollback Angle	44°
Digging Depth Below Grade	6.3"
Overall Height in Carry Position	66.7"
Depth of Attachment (to back of inner shell)	21.6"
Height of Attachment	22.8"
Depth of Attachment (to pivot pin)	29.1"
Bucket Size	80"
Rated Bucket Capacity	12.43 cu.ft.
Heaped Bucket Capacity	19.21 cu.ft.
Relief Valve Setting (Loader Control Valve)	2630.7 psi
Rated Flow (Tractor Sytem)	10.57 GPM
Approximate Weight with Bucket	1369 lbs
Bucket Size Used for Specification	80"
Lift Capacity to Full Height at Pivot Pins	2506 lbs
Breakout Force at Pivot Pin	3916 lbs
Lift Cylinders	2.3"x20.1"
Bucket Cylinder	2.5"x14.1"
Raise Boom (seconds)	4.3
Lower Boom (seconds)	2.9
Dump Bucket (seconds)	3.1
Retract Bucket (seconds)	2.0

*Specifications and design are subject to change without notification.

Specifications



ISO 9001
NO:954596



ISO 14001
NO:771475



OHSAS 18001
NO:K033008

MODEL	RX6010PC Power Shuxttle	RX6010C Mechanical Shuttle
ENGINE		
Manufacturer	Daedong	
Model	4B243TLWM-K	4B243TLWM
Engine Gross Power (HP)	59	
Rated speed (rpm)	2600	
Type	Water Cooled, 4Cycle, Turbo Diesel	
No.of cylinders	4	
Total displace (cc)	2435	
Turbo Charge	Turbo charged	
CAPACITY		
Fuel tank capacity (ℓ)	90	
Engine oil (Filter included) (ℓ)	7.7	
Engine coolant (ℓ)	9.1	
Transmission case (ℓ)	58	
Front axle case (ℓ)	8.5	
PTO		
PTO Power (HP)	49.1	
Rear PTO		
Revolution (rpm)	2nd : 540, 1000	
Type	Independent	
HYDRAULIC		
Lift Control Type : Standard	Position, Draft and Mixed Control	
3-point hitch	Category II	
Lift capacity at lift point (kg.f)	2378	
Cylinder type	Exterior	
No. of standard remote valves	1st : Std. 2nd, 3rd : Opt.	
TRAVELLING SYSTEM		
Transmission	PowerReverse 12F/12R	12F/12R
shuttle Type	Hydraulic shuttle	Mechanical Shuttle
Steering	Hydrostatic power steering	
Brake	Wet multi disc type	
Main Clutch type	Multi wet disc clutch	Dry single disc clutch
Mechanical differential lock	Rear Standard	
4WD type	Electric/Hydraulic Actuation	
TIRE SIZE		
Front / Rear (AG.)	11.2-20 / 14.9-30	
Front / Rear (IND.)	12.5/80-18 / 18.4-24/8	
Front / Rear (TURF.)	31X13.5X15/8 / 44X18X20/4	
TRAVEL SPEEDS		
Forward (km/h)_AG.	1.93~32.72	
Reverse (km/h)_AG.	1.90~32.17	
Forward (mph(km/h))_IND.	1.14 ~ 19.25 (1.83 ~30.98)	
Reverse (mph(km/h))_IND.	1.12 ~ 18.93 (1.80 ~ 30.46)	
OTHER FEATURES		
Tilt steering	Standard	
Hood type	One-Touch Hood type	
Deck type	full-flat	
Panel type	Electric	
DIMENSIONS_IND.		
Overall length (mm)	4020	
Overall width (min. tread) (mm)	1755	
Overall height (with CABIN) (mm)	2600	
Wheelbase (mm)	2100	
Ground clearance (mm)	420	
Min. turning radius(w/brake) (mm)	3110	
Weight (kg.f)	2610	

*NOTE : Specifications and design are subject to change without notice.

Standard Equipment

- Hydrostatic Power Steering
- Rear Differential Lock
- Hydraulic Brakes
- Adjustable Drawbar/Adjustable Seat
- Head Lights / Safety Lights
- Cup Holder
- Sunvisor
- 1st Remote Hydraulic Valves
- Rear View Mirror
- 7 Pin Socket
- Draft Control
- Joystick Valve
- Auto 4WD
- Rear PTO
- Front Wiper
- Cabin

Optional Equipment

- 2nd, 3rd Remote Hydraulic Valve (Normal/Detent Floating Valve)
- Front Weights
- Rear Weights
- Beacon wire harness
- AM/FM Radio CD Player
- Towing Hook
- Rear Wiper
- Room Mirror



**Kioti Tractor/
Daedong Industrial. Co., Ltd.**
1422-5, Seocho-Dong, Seocho-Ku, Seoul, Korea
tel 82-2-3470-74549 • fax 82-2-3470-7485
web www.daedong.co.kr

Dealer Imprint Area

KIOTI UTILITY TRACTOR

RX6010C / RX6010PC



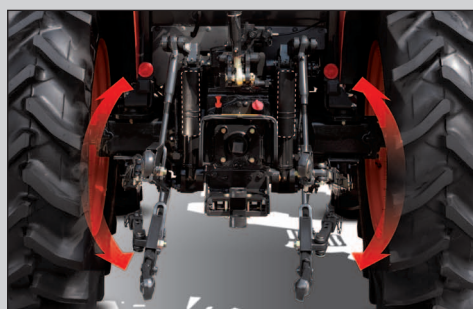

External Hydraulic Cylinder

The RX series tractor has two external hydraulic lift cylinders (left and right) with lift capacity of 2,378 kg.f.



Elegant Grill and Hood

The new streamlined hood design improves the visibility of the operator. The 60 degrees hood opening angle enables convenient access for better maintenance.

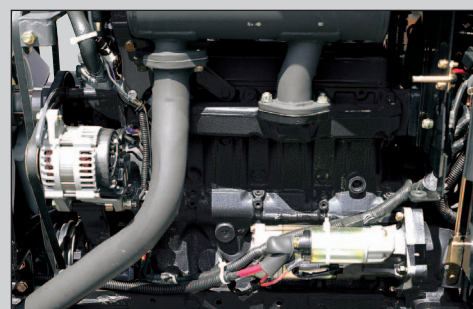

Powerful Environmentally Friendly Turbo Engine

The powerful 59hp Turbo Engine will offer the operator a quiet and smooth environment as well as powerful workhorse.



AUTO and Hydraulic PTO

The standard rear PTO is easily engaged by the simple push of button and selecting either manual or automatic operation. For added safety, the AUTO PTO function can be selected to automatically stop the PTO when the implement is raised by the control lever ; eliminating exposure to the moving parts. A safety interlock prevents engine start when the PTO switch is left on.

RX6010C/RX6010PC series

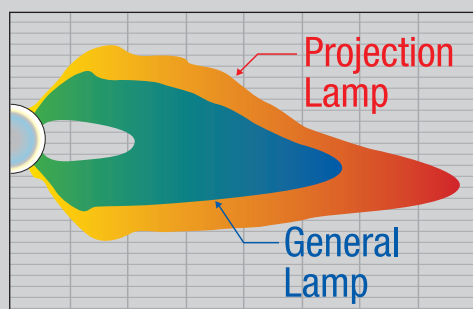

New Projection Head lamp

With the new projection headlamp and working lamp, the operator will experience safer and easier operation in dark operating conditions.

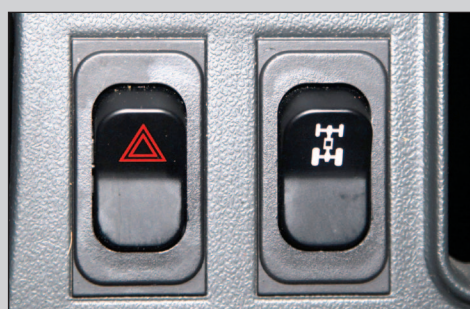

Hydraulic 4WD

The 4WD is engaged with the simple push of a button.

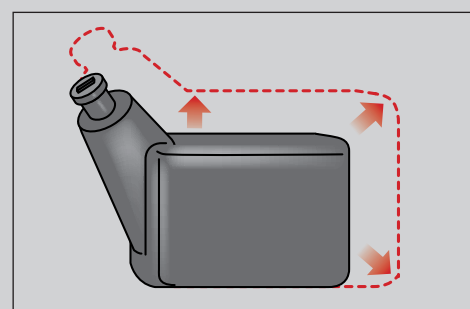

Fuel Tank(90ℓ)

The 90 liter fuel tank allows productive working hours without the need for frequent re-fueling.



Power Shuttle Lever(RX6010PC)

The Power Shuttle Lever provides easy forward and reverse operation without stepping on a clutch pedal.



Power and Tilt Steering Wheel

The standard power steering minimizes the effort required to make tight, repetitive turns. The steering wheel tilts with the simple push of a lever, allowing easy adjustment to fit the operators needs.

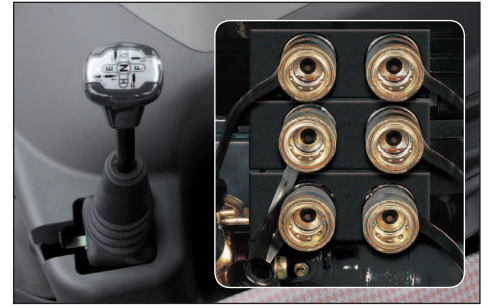

Remote hydraulic valve

Standard dual remote hydraulic valves (2nd, 3rd optional) accommodate a wide variety of attachments and implements. The mid-mount hydraulics and a single lever joystick for loader operations are standard on the RX series.

Front Glass

The upgraded sealing on the front glass offers improved field of vision with better noise suppression.

Luxury Cabin

The new comfortable cabin with upgraded interior minimizes operators fatigue even after long days of work.

